

urban

urbanArt
Environment





IN 01

Indoor paper bin (perforated steel)
Dimensions:
Height: 340 mm
Diameter: 250 mm
Capacity: 15 L



IN 02

Indoor paper bin (bright or brushed steel)
Dimensions:
Height: 480 mm
Diameter: 250 mm
Capacidade: 23 L



IN 03

Round paper bin
Dimensions:
Height: 320 mm
Diameter: 250 mm
Capacity: 15 L



IN 04

Indoor paper bin (black or brushed steel)
Dimensions:
Height: 320 mm
Diameter: 250 mm
Capacity: 15 L



IN 08

Indoor paper bin (bright or brushed steel)
Dimensions:
Height: 320 mm
Diameter: 250 mm
Capacity: 15 L



IN 09

Square paper bin
Dimensions:
Height: 485 mm
Width: 245 mm
Capacity: 27 L



IN 11

Paper bin in iron lidded tilting stainless
Dimensions:
Height: 630 mm
Width: 280 mm
Length: 330 mm
Capacity: 51 L



IN 12

Rectangular paper bin
Shiny or brushed stainless steel options
Dimensions:
Height: 750 mm
Width: 214 mm
Length: 227 mm



IN 13

Paper bin in coated iron plate the semi-skin rim stainless background
Dimensions:
Height: 320 mm
Diameter: 250 mm.
Capacity: 15 L



IN 14

Paper bin in shiny stainless steel or painted iron plate with pedal
Dimensions:
Height: 610 mm
Diameter: 360 mm.
Capacity: 45L



IN 15

Sheet metal tray with epoxy paint.
Rubber mounts for contact with the ground
Dimensions:
Height: 305 mm
Width: 170 mm
Length: 320 mm
Capacity: 16 L



IN 16

Iron plate Metallic and lacquered
Dimensions:
Height: 900 mm
Width: 500 mm
Length: 300 mm.
Fixation through metal bushings.
Capacity: 60 L



IN 17

Brushed stainless steel
Dimensions:
Height: 630 mm
Width: 260 mm
Length: 310 mm
Capacity: 37 L



IN 18

Paper bin stainless steel
Dimensions:
Height: 620 mm
Width: 245 mm
Length: 245 mm
Capacity: 36 L



SM 01A | SM 01B

Stationer ashtray in brushed stainless
Dimensions:
Height: 600 mm
Diameter: 210 mm
Capacity: 15 L



SM 02

Stationer ashtray top opening;
In perforated plated painted
Height: 650 mm
Diameter: 250 mm



SM 03 A | SM 03B

Ashtray with an opening;
Shiny or brushed stainless steel
options
Height: 600 mm
Diameter: 210 mm
Capacity: 14 L



SM 04

Stainless steel or painted iron paper bin
Dimensions:
Height: 610 mm
Diameter: 250 mm
Capacity: 18 L



SM 05

Brushed or bright stainless steel
Dimensions:
Height: 700 mm
Diameter: 250 mm
Capacity: 20 L



SM 06

Paper bin with two openings.
Dimensions:
Height: 600 mm
Diameter: 250 mm
Capacity: 18 L



SM 07

Square format, painted body and ashtray in stainless steel.

Dimensions:

Height: 570 mm

Width: 200 mm

Capacity: 12 L



SM 08

Brushed stainless

Dimensions:

Height: 640 mm

Diameter: 125 mm



SM 09B

Rectangular format dump.

Options in brushed stainless steel, painted or bright.

Dimensions:

Height: 420 mm

Width: 315 mm

Depth: 150 mm



SM 10

Material: Brushed stainless steel

Dimensions:

Height: 830 mm

Diameter: 500 mm



SM 11

Ashtray papermaker round

Brushed stainless

Dimensions:

Height: 610 mm

Diameter: 250 mm

Capacity: 18 L



SM 12

Perforated papermaker ashtray stainless steel plate;

Dimensions:

Height: 610 mm

Diameter: 250 mm

Capacity: 18 L



SM 91

Stainless steel paper ashtray or galvanized sheet

Dimensions:

Height: 680 mm

Diameter: 364 mm

Capacity:

Paper bin: 45 L

Ashtray: 0.85 L

OUT 01

Garden paper bin in steel

Dimensions:

Altura: 960 mm

Diameter: 380 mm

Capacity: 32 L



OUT03A e OUT03B

Garden paper bin in stainless steel or painted steel

Halfpipe shape

Dimensions:

Height: 820 mm

Diameter: 460 mm

Capacity: 50 L



OUT 02 A | OUT 02 B

Garden paper bin in steel

Dimensions:

Height: 820 mm

Diameter: 360 or 440 mm

Capacity: 42 L



OUT 05

Garden paper bin in stainless steel

Option: Ashtray

Dimensions:

Height: 750 mm

Width: 475 mm

Depth: 185 mm

Capacity: 43 L



OUT MB

Paper bin in resistant stainless steel

Dimensions:

Height: 500 mm

Width: 150 mm

Depth: 230 mm

Capacity: 13 L



OUT 06

Paper bin with ashtray in stainless steel

Dimensions:

Height: 930 mm

Width: 295 mm

Depth: 255 mm



ECO-ROOF

Material: Painted iron plated
3 containers (glass, paper/ cardboard, plastic/ metal)
Dimensions of each container:
Height: 700 mm | Width: 250 mm | Length: 310 mm
Capacity: 38 L



ECO-MOVE

Material: Painted iron plated
3 containers (glass, paper/ cardboard, plastic/ metal)
Dimensions of each container:
Height: 600 mm | Diameter: 360 mm
Capacity: 45 L



ECO-PULL

Material: Painted iron plated
3 containers (plastic/ metal, glass, paper/ cardboard)
Dimensions of each container:
Height: 415 mm | Diameter: 250 mm
Capacity: 20 L



ECO-9

Block Eco-point with 4 rounds of selective recycling, made of sheet steel or stainless steel.
Dimensions of each container: 750x300x1030 mm
Capacity: 50 L



ECO-FOUR | ECO-ASH (with ashtray)

Stainless steel block
3 units
Unit Dimensions ECO-FOUR :
(paper/ cardboard) height 830mm x diameter 250mm - 41L
(glass) height 730mm x diameter 250mm - 36L
(trash) height 730mm x diameter 250mm - 36L
(plastic/ metal) height 630mm x diameter 250mm - 30L

Unit Dimensions ECO-ASH:
(paper/ cardboard) height 730mm x diameter 250mm - 36L
(trash) height 830mm x diameter 250mm - 41L
(plastic/ metal) height 625mm x diameter 250mm - 30L
(ashtray) height 1000mm x diameter 125mm



ECO-6

Plastic Material
(glass, paper/ cardboard, plastic/ metal)
Dimensions of each container:
Height: 400 mm | Depth: 465 mm
Width: 245 mm
Capacity: 10 L per container



ECO-8

Stainless steel
3 units changeable colors
(glass, paper/ cardboard, plastic/ metal)
Dimensions:
Height: 800 mm | Diameter: 630 mm
Capacity: 220 L



ECO-7

4 full stainless steel or painted iron block containers (glass, paper / cardboard, plastic / metal and undifferentiated)
Dimensions of each container: Height: 745 mm | Front: 1030 mm | Width: 250 mm
Capacity: 42 L per container



Recycling is a civic duty. Campaigns for the preservation of the environment are increasingly impacting and raising awareness of more people.

The can compactor aims to encourage people to the importance of recycling. Through a simple compaction system, which is activated mechanically through the lever, the cans are pressed to save space in the waste container. It becomes a fun, very practical and safe gesture.

CL 2000

Glass fiber cover and base;
Drive arm (galvanized steel tube);
Crushing piston;
Shock absorbers;
Bag-holder;
Door lock;
Front mouth with a diameter of 90 mm;
Rubber windows, for the introduction of cans with greater security;
Dimensions: Diameter: 600 mm | Height: 1153 mm;
Capacity: 2000 compressed cans;
Available in various colors and customizable decoration.



deposit the can



pressionne a alavanca

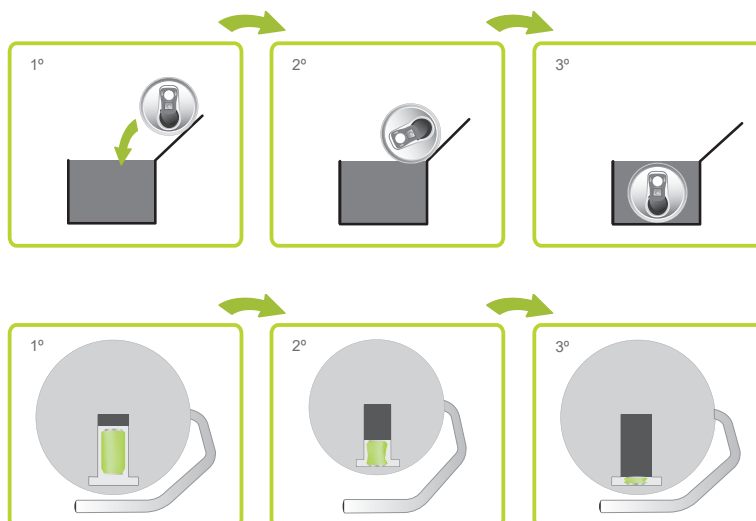
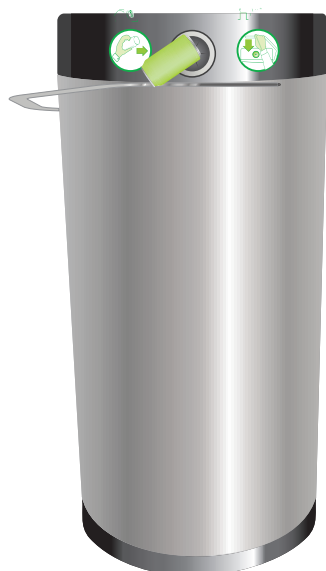

Camouflage system for garbage containers 800 and 1100 Liters.

The system bases its concept on simplicity of operation and installation, enhancing the efficiency gain of the collection. The equipment does not require expensive hydraulic connections and complex mechanisms allowing very low maintenance costs.

A metal net is manufactured in AIS 316 stainless steel panels by MIG-MAG welding with welding wire of the same quality (aisi 316), suitably pickled.

Triangular reinforcement handles and anchoring and fixing tents in AISI 316 stainless steel, screwed by A1 stainless steel screw. The system is supplied in kits for 1,2,3,4 or 5 containers with wood ripping and exterior fittings for assembly.



DRS 800/1000/1100



Material: Stainless steel

Optional

Models available in stainless steel or galvanized pipe;
Container supports of 800 liters, 1000 liters and 1100 liters;
Fixation in the ground is done by means of plumbing;
It has an anti-theft security system.
Advertising space (customizable on request)
in flat plate and stop for cover, optional;



Material: Galvanized tube

Optional

Prevent from thunderstorms.
In case of floods, winds, heavy rains or even vandalism,
the system prevents the container from floating, falling or moving
local due.

Carros de Limpeza

EQL - CL1

Urban cleaning cart in stainless steel;
Includes: 2 containers in polyethylene (120 L), broom and shovel in
aluminum.
Possibility to include inscriptions or logos.



EQL - CL2

Stainless steel cleaning trolley;
Includes: 1 polyethylene container (95 L),
aluminum broom and shovel.
Possibility to include inscriptions or logos.





Urban Furniture

FL 01 A | FL 01 B



Flower pot with inner pot
Capacity: 31 L
Length: 350 mm
Width: 350 mm
Height: 315 mm

FL 02



Stainless steel flower pot
(s / interior)
Capacity: 95 L
Length: 490 mm
Width: 490 mm
Height: 400 mm

FL 03 B



Stainless steel perforated
flower pot with inner pot
Capacity: 72 L
Height: 440 mm
Diameter: 495 mm

FL 03 C | FL 03 D



Natural stainless steel
flower pot or with any color
paint
with inner vessel
Capacity: 25 L
Height: 285 mm
Diameter: 340 mm

FL 400/F2



Rectangular fiber flower pot
Capacity: 155 L
Height: 410 mm
Width: 1200 mm
Depth: 400 mm

FL 400/F1



Square flower pot
totally in fiberglass
Capacity: 55 L
Height: 410 mm
Width: 400 mm
Length: 400 mm

CORTEN 1



Corten steel flower pot
Capacity: 80 L
Height: 300 mm
Width: 1000 mm
Depth: 280 mm

CORTEN 2



Corten steel square flower
pewter
Capacity: 70 L
Height: 615 mm
Upper: 450 mm
Bottom: 255 mm

LIMIT V1/V2

Dimensions:
Diameter: 76 / 90mm
Height: 1000 mm
Available with reflective screen
Fixing by bushing



LIMIT V3/V4

Dimensions:
Diameter: 76 mm
Height (at the surface):
750 mm (V3) / 1000mm (V4)
Spherical aluminum top



LIMIT V5

Dimensions:
Diameter: 84 mm
Height: 350 mm
Material: Stainless steel
Fastening with screws to the floor



LIMIT V6

Dimensions:
Diameter: 84 mm
Height: 850 mm
Fixing: Down to the floor



LIMIT V7

Dimensions:
Diameter: 219 mm
Height: 700 mm
Material: 304 polished steel with natural color
Deep burial
200mm



LIMIT V8

Dimensions:
Width: 80 mm
Height: 1000 mm
Material: Iron with finish
galvanized and lacquered
Binding fixture with
depth of 200 mm



LIMIT V10

Dimensions:
Width: 80 mm
Height: 700 mm
Metallic and lacquered finish
Fastening through metal bushes
Folding option: FALL V10
Removable option: TK10



LIMIT V11

Dimensions:
Width: 175 mm
Depth: 70 mm
Height: 700 mm
Metallic and lacquered finish
Fastening through metal bushes
Folding option: FALL V11
Removable option: TK11



FALL V1/V2

Dimensions:

FALL V1 - (height) 1000 mm x (diameter) 76 mm

FALL V2 - (height) 1000 mm x (diameter) 90 mm

Round steel tube, 90 mm in diameter,

hot galvanized and lacquered;

With or without reflective screen;

Removable top with wrench.



Série Take - Amovíveis

TK01

Dimensions:

Diameter: 102 mm

Height: 1000 mm

Material: Zinc plated and lacquered steel tube
with stainless steel ring

Cup-and-socket attachment



TK05

Dimensions:

Diameter: 90 mm

Height: 1000 mm

Material: 2 mm thick tube
metallised and lacquered

Cup-and-socket attachment



DESCRIPTION

Side ring in aluminum profile with color to be defined;
Possibility of being lit or not;
Aluminum front and rear panel;
Metallic interior structure with shoe for fixing to the ground;
Decorating in reflective canvas and / or digital printing or vinyl.

DIMENSIONS:

1250 x 3000 mm (example)



SÉRIE BOX



Box in galvanized or stainless steel sheet;
Possibility of lighting, (with or without solar panel);
Decoration on vinyl or digital printing;
Dimensions (variable)
Simple or double face.

SÉRIE COLUNATA



Two polished round poles;
Galvanized or stainless steel sheet;
Decoration on vinyl or digital printing;
Dimensions (variable)
Double or single face.

SÉRIE WAY

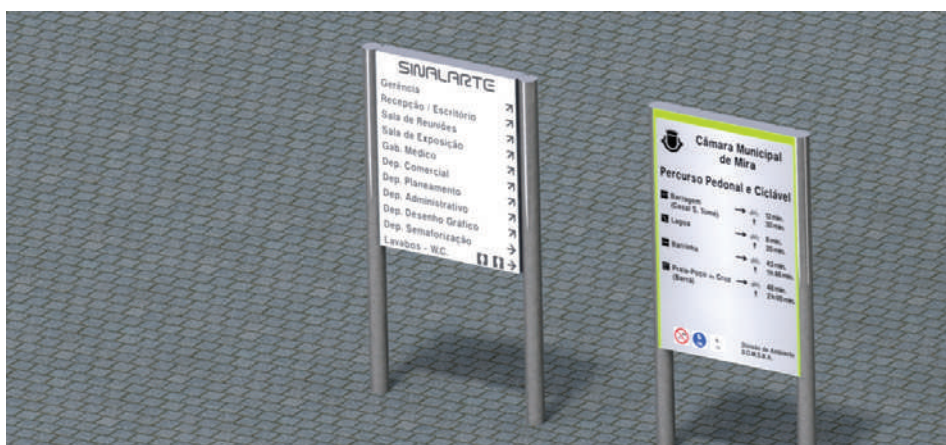

Two rectangular lacquered posts;
Galvanized or stainless steel sheet;
Decoration on vinyl or digital printing;
Rulers in aluminum profile;
Variable dimensions:
e.g., 700x75 mm

SÉRIE TOTEM CANINO



Aluminum structure
Decoration on vinyl or digital printing;
Dimensions:
Height Variable: Ex: 1600 mm
Width: 300 mm
Thickness: 45 mm
Aluminum base: 350x350 mm



MATERIAL:

Front - AISI 346 stainless steel with 2 mm thickness with laser cut inscriptions.

Back - Galvanized and painted sheet.

Dimensions: 2400 x 1000 mm.

Base in bent sheet for grounding.

Backlit LED for night time.

Série Portimão

MATERIAL:

Stainless steel

Panel Dimensions: Width: 400 mm | Thickness: 120 mm | Height: 2000 mm

PHOTOVOLTAIC PANEL CHARACTERISTICS:

Rated power: 20W;

Operating Voltage (Vmp): 17V;

Operating Current (Imp): 1.14A;

Short Circuit Voltage (Voc): 21.7V;

Short circuit current (Ioc): 1.25A;

Dimensions: 630x290x28 mm

BATTERY CHARACTERISTICS:

Voltage: 12 V

Capacity: 20Ah

CHARGER REGULATOR:

Charging current: 6A;

Twilight control;

Battery overload protection (13.9V);

Protection under battery power (11.2 ... 11.6V).

- 1 space for logo
- 2 pedestrian path
- 3 informative text
- 4 braille information text



DIV 02 i | DIV 02 p

Column in stainless steel or painted;
Column - H.: 970 mm | Diam. base: 305 mm;
Tube diameter: 50 mm;
Tape - Width: 25mm | Compress.: up to 2,5 mts;
Ribbon available in red, blue or black color.



DIV 01 A

Brushed stainless steel column;
Dimensions of the column:
970 mm | Diam. of the base: 340 mm
Diameter of the tube: 50 mm.



DIV 01 B

Steel column with epoxy paint;
Dimensions of the column:
970 mm | Diam. of the base: 340 mm
Diameter of the tube: 50 mm.



DIV 01 C

Steel column with epoxy paint;
Dimensions of the column:
970 mm | Diam. of the base: 340 mm
Tube diameter: 50 mm;



DIV 02 B

Twine with a diameter of 25 mm and
maximum width 2000 mm;
Cord available in red,
blue or black.



ACCESSORIES: Wall System

Easy placement;
Column - Height: 115 mm | Diameter: 70 mm;
Tape: 25 mm in diameter | Larg. max.: 2500 mm;
Ribbon available in red, blue or black color.



Information Sign

Attachable to separator columns;
Material: acrylic;
Size A4.



Bike 1

Stationary in stainless tube for bicycles.

Dimensions:

Height: 190 mm

Loop: 380 mm

Depth: 2000 mm



Bike 2

Spiral bicycle parking unit.

Dimensions:

Diameter: 570 mm

Length: 1450 mm



Edition 2019



www.sinalarte.pt

Zona Industrial de Oia - Lote C25 | Apartado 50 | 3770-908 Oia
Tel.: (+351) 234 729 130 | Fax.: (+351) 234 729 131
geral@sinalarte.pt

Find us on:



Conceção, Desenvolvimento,
Fabricação e Comercialização
de Sinalização Rodoviária,
Semaforização, Mobiliário Urbano
e Sistemas de Iluminação com LED's